

**BUILDING PLOT WITH ADDITIONAL PADDOCKS AT REAR IN GREAT TEY ROAD, COLCHESTER. SOLD SUBJECT TO CONTRACT**

Building plot of approx. 0.35 hectares with additional paddock at rear of approx. 0.28 hectares. Total plot area approx. 0.64 hectares in Great Tey Road, Colchester.

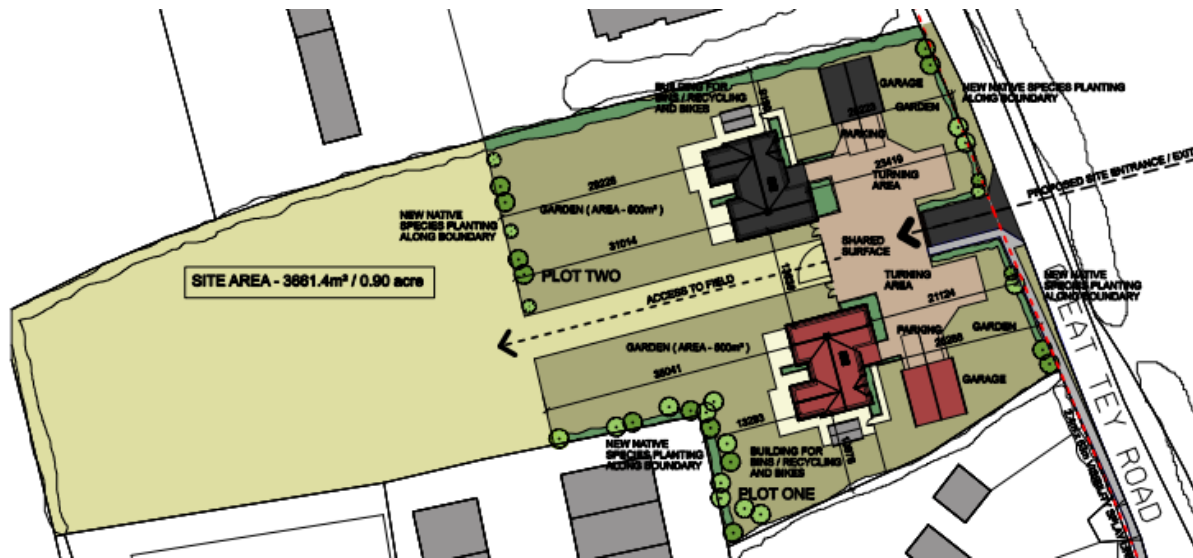

Development site area = 0.36 hectare

Paddocks at the rear area = 0.28 hectare

**Total plot area = 0.64 hectare**

An appeal has been allowed and planning permission granted in November 2020 for two detached four bedroom dwellings together with detached double garages, formation of a new access drive, landscaping and the provision of an extension of the public footpath from the junction of Coggeshall Road with Great Tey Road onto the formation of the new access off Great Tey Road.



Further details available on request.

Elevations of proposed houses from Great Tey Road